

REHAU SLINOVA SLIDING DOOR SYSTEM

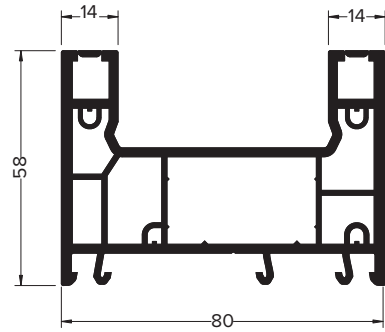

Main Profiles

Note: The below foiled part numbers will precede a 3 digit colour variant number



575602
595802 (Foiled)
Reinforcement 35 x 20
DOOR FRAME

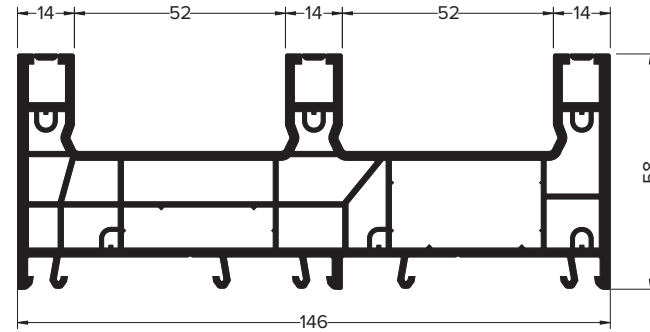

575603
595803 (Foiled)
Reinforcement 35 x 20 & Reinforcement 35 x 8
TRIPLE TRACK FRAME

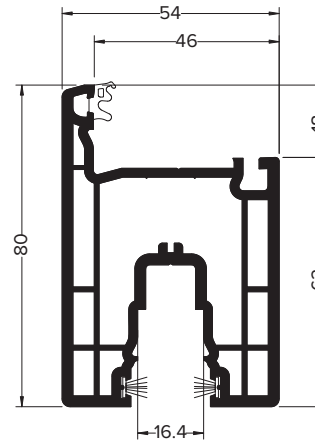

575305
595405 (Foiled)
Reinforcement 34.5 x 40.8
DOOR SASH

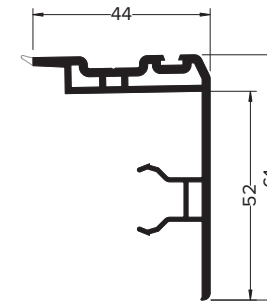

575506
595606 (Foiled)
INTERLOCK

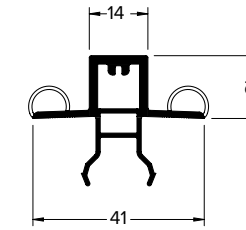

575507
3/4 PANE SEAL

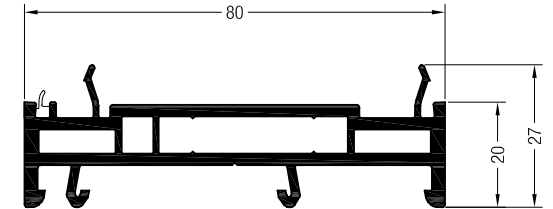

538025
568025 (Foiled)
Reinforcement 35 x 6
20MM FRAME EXTENSION

Finishing Profiles

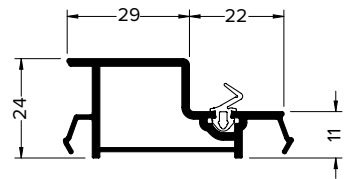

575626
595726 (Foiled)
COVER PROFILE

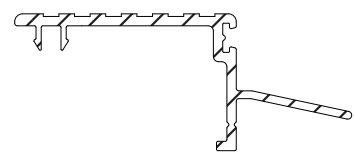

368136
STANDARD TREAD PLATE

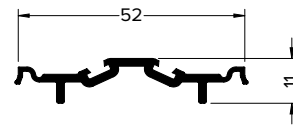

575622
THERMAL PROFILE WITH DRAINAGE

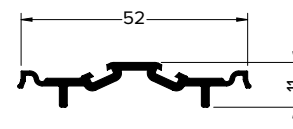

575722
THERMAL PROFILE NO DRAINAGE

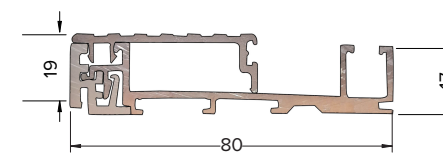

LOW ALI THRESHOLD

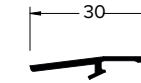

362276
FINISHING TRIM



372962
SILL ADAPTOR

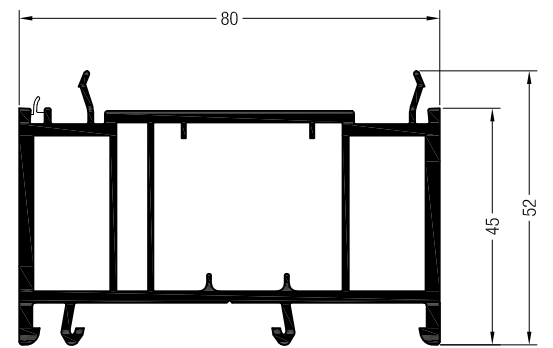

538045
568045 (Foiled)
Reinforcement 23 x 28
45MM FRAME EXTENSION

Glazing

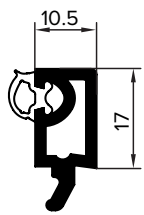

559605
589605 (Foiled)
28MM BEAD

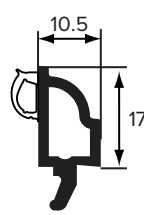

559600
589600 (Foiled)
28MM SCULPTURED BEAD

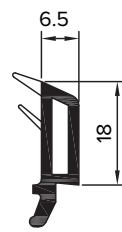

560580
594330 (Foiled)
32MM BEAD

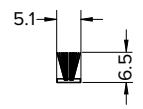

334728
5.1 x 6.5mm BRUSHPILE
for interlock & treadplate

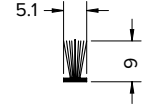

357855
5.1 x 9mm BRUSHPILE
for thermal profile

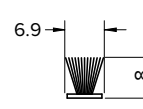

371038
6.9 x 8mm BRUSHPILE
for cover profile

Reinforcement

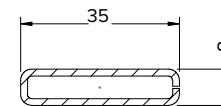

357835
REINFORCEMENT
35 X 8 X 1.5MM

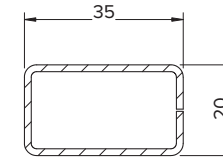

357836
REINFORCEMENT
35 X 20 X 1.5MM

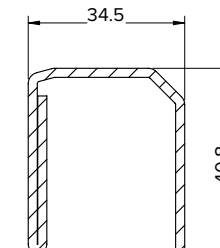

357832
REINFORCEMENT
34.1 X 40.8 X 2MM

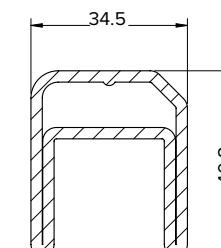

357833
REINFORCEMENT
34.1 X 40.8 X 2.5MM

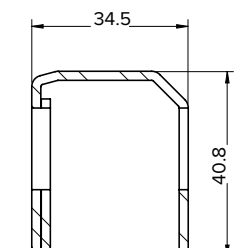

361488
REINFORCEMENT
34.1 X 40.8 X 2MM

Ancillaries

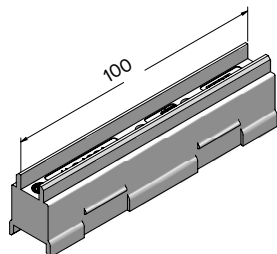

357849
SASH SPACER

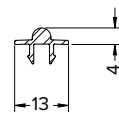

357837
RUNNING TRACK

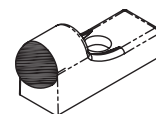

318023
DOOR BUMP STOP
for use on triple track doors only

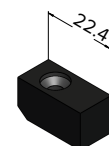

362274
CORNER BUNG

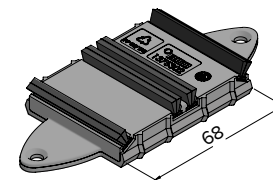

375302
ANTI-LIFT BLOCK

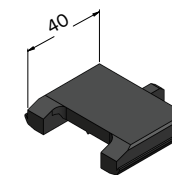

362525
ANTI-LIFT BLOCK EXTENSION

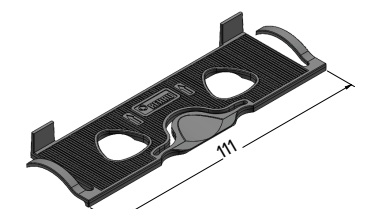

375310
GLAZING PACKER